



Information as of August 1, 2014

## Advanced Utility Work for Laird West Headwall Construction Starting the Week of August 5, 2014

The Eglinton Crosstown is a 19-kilometre light rail transit (LRT) line that will run along Eglinton Avenue through the heart of Toronto, with an underground central section. The line will connect Mount Dennis in the west to Kennedy Road in the east, and the new service will be up to 60% faster than the bus service today.

**What:** Crews will be working on advanced utility construction and relocation, just to the east of the intersection of Eglinton Avenue East and Sutherland Drive.

**Why:** Headwalls are required to be in place prior to the arrival of tunnel boring machines at each of the stations and emergency exit building locations. Construction of the headwalls requires utilities to be moved safely out of the way before work begins. Depending on site conditions, gas, hydro, water mains, sewers, traffic street lighting and telephone lines may be relocated to allow for the construction of headwalls.

**When:** Starting as early as the week of August 5, 2014, for approximately two weeks, crews will be working on Eglinton Avenue East, within the roadway just east of Sutherland Drive. Work will take place in three stages. Each stage is expected to last approximately three days. Some work may be rescheduled or adjusted due to weather conditions and unforeseen circumstances.

### Where and Traffic Details:

#### Stage One– North Side Utility Work

- During the first stage of construction, a work zone will be set-up on the north side of Eglinton, just east of Sutherland Drive and will extend eastward until the approximate location of the first hydro pole.
- As a result of advanced utility work on the east side of the intersection of Eglinton Avenue East and Sutherland Drive, the westbound curb lane on Eglinton Avenue East will be occupied as work zone. Westbound traffic will be gradually shifted to the centre lane around the work zone. At the intersection, all lanes will gradually re-open.
- Westbound cars will be permitted to turn left, proceed westbound and turn right at Sutherland Drive.

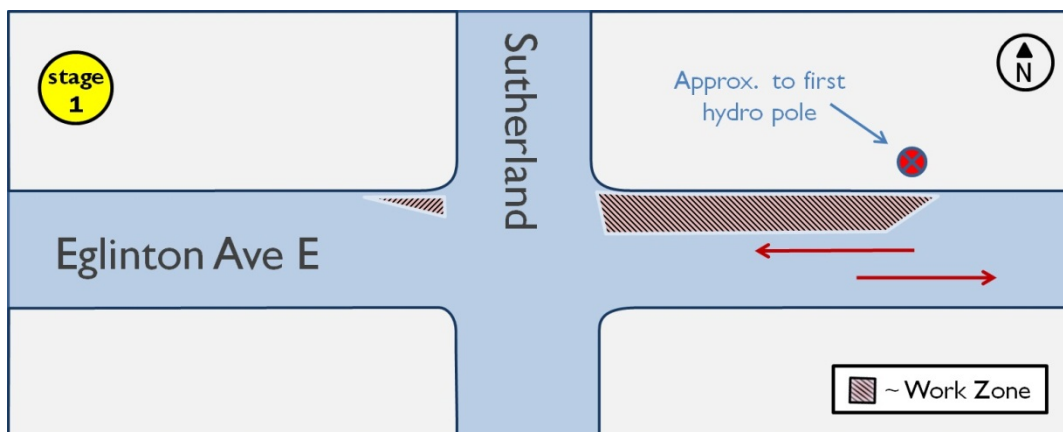

#### Stage Two – Middle Lanes Utility Work

- During the second stage of construction, a work zone will be set-up in the middle two lanes of Eglinton, just to the east of Sutherland Drive and will extend eastward until the approximate location of the first hydro pole.
- The middle westbound and eastbound lanes will be occupied as a work zone.
- Starting just west of the Sutherland/Eglinton intersection, eastbound traffic will be gradually shifted one lane to the south around the work zone. Eastbound cars will be permitted to turn left, proceed eastbound and turn right at Sutherland Drive.
- Westbound Eglinton traffic approaching the Sutherland intersection will be gradually shifted one lane to the north around the work zone. Westbound cars will be permitted to turn left, proceed westbound and turn right at Sutherland Drive.

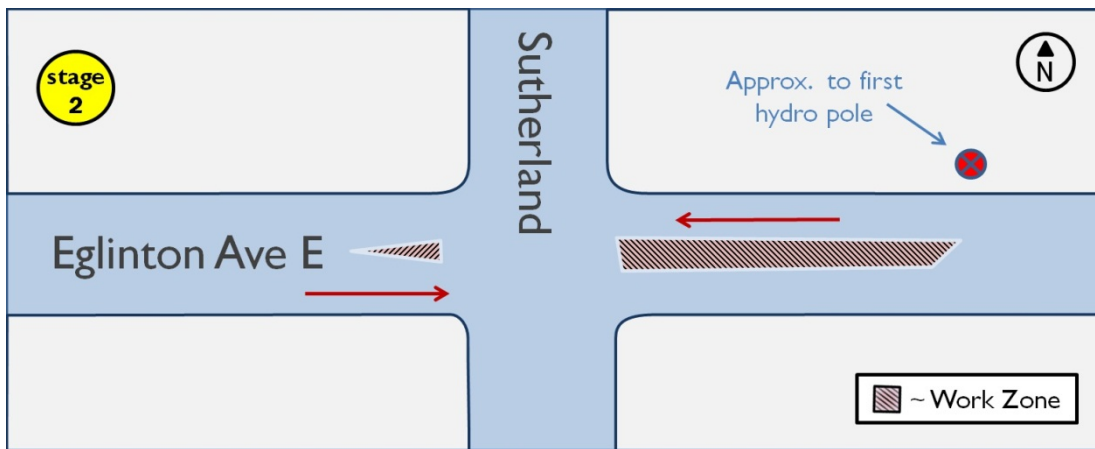

### Stage Three – South Lane Utility Work

- During the third stage of construction, a work zone will be set-up on the south side of Eglinton Avenue East, just to the east of Sutherland Drive and will extend eastward until the approximate location of the first hydro pole.
- Eastbound curb lane on Eglinton Avenue East will be occupied as work zone. Eastbound traffic will be gradually shifted to the centre lane around the work zone.
- Eastbound cars will be permitted to turn left, proceed eastbound and turn right at Sutherland.

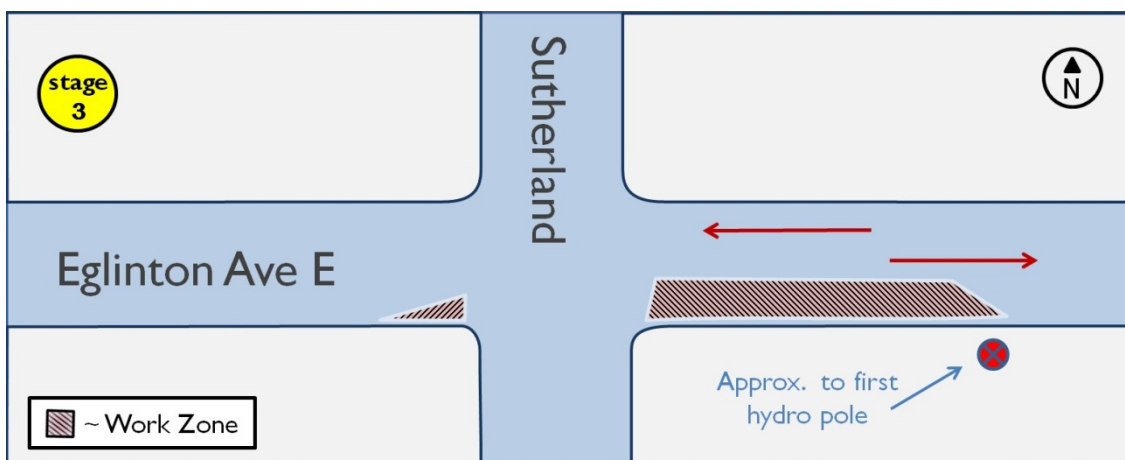

Traffic patterns in the area will continue to change and shift during different phases of the work, a paid-duty office will be on-site. All work zones will be separated from the right-of-way with traffic cones. Traffic delays are expected during construction. Please watch the traffic signs and take care when travelling near construction areas.

### **Work Hours**

Most of the work will be carried out between 7:00 a.m. and 11:00 p.m., seven days a week. In certain situations, some late night and/or early morning works may be required to complete the work and keep construction moving. The contractor will not always work during the extended hours, but may do so at its discretion.

### **Please Contact Us**

If you would like more detail about this work or any other aspect of the Eglinton Crosstown project, please do not hesitate to contact us. We thank you for your continued patience as we work to build rapid transit.